

Modular type Air Unit(AF+AR+AL)

Filter + Regulator + Lubricator

SAU2000M~6000M Series

How to order

SAU 30 00 M-03 DG-Me

- 1 Air Unit
- 2 Body Size
 - 20 - 1/4
 - 30 - 3/8
 - 40 - 1/2
 - 60 - 1
- 3 Composition
 - 00 - AF+AR+AL
 - 10 - AW+AL
 - 20 - AF+AR
 - 30 - AF+AFM+AR
 - 40 - AW+AFM
 - 50 - AFM+AFD+AR
 - 60 - AW+AFM+AFD
- 4 Port Size
 - 02 - Rc(PT) 1/4 "
 - 03 - Rc(PT) 3/8 "
 - 04 - Rc(PT) 1/2 "
 - 06 - Rc(PT) 3/4 "
 - 10 - Rc(PT) 1 "
- 5 Accessory(Optional)
 - Nil - Manual Drain
 - D - Auto Drain
 - G - Gauge
- 6 Option
 - Nil - PC Bowl
 - Me - Metal Bowl



Symbol

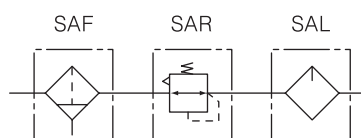

Specification

Combination	Filter Regulator Lubricator
Max. supply pressure	1.5MPa [15.3 kgf/cm ²]
Max. operating pressure	0.97MPa [9.9 kgf/cm ²]
Regulating range	50~850kPa [0.5~8.7 kgf/cm ²]
Ambient and media temperature	5 ~ 60°C
Filtration	Standard:10μm, Option:2, 5, 20, 40
Recommended oil	Turbin oil (ISO VG32)
Bowl material	Poly-carbonate · Metal
Construction / Regulator	Relief type

Precautions

- ① Poly-carbonate bowls may be damaged and highly possible to fail if exposed to synthetic oils, thinner solvents, trichloroethylene, kerosene, chloroform, cyclohexane or other aromatic hydrocarbons and such environment exposed chemicals such as above.
- ② When auto drain is used :
Drain piping should be both 4mm or greater in diameter and less than 1m in length.
Also should avoid setting drain piping upwards.
- ③ When auto drain is out of order, it is possible to drain manually by operating one-touch-fitting vertically.
- ④ With a drain cock attached, drain can be done when the head of liquid is shown at the glass indication tube.

SAU

SAU(AF+AR+AL) Series

● FLOW CHARACTERISTICS

SAU 2000M

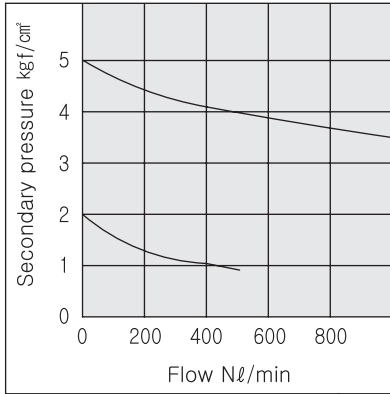

SAU 3000

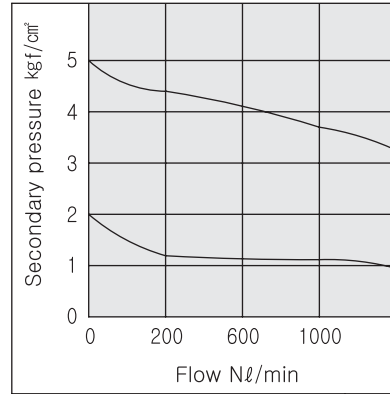

SAU 3000M

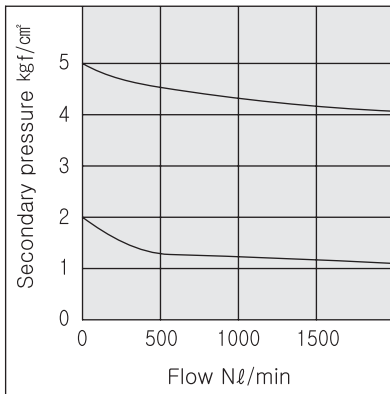

SAU 4000M-04

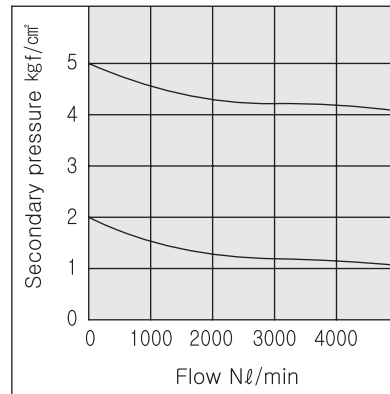

SAU 4000M-06

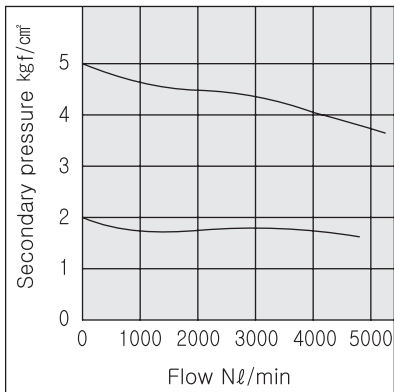

SAU 6000M

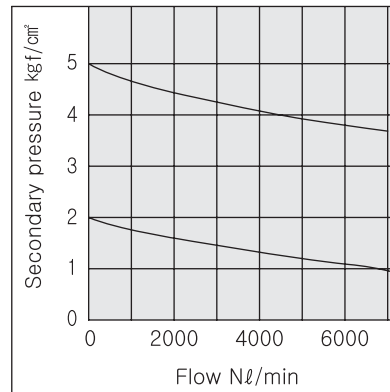

SAU(AF+AR+AL) Series

● PRESSURE CHARACTERISTICS

SAU 2000M

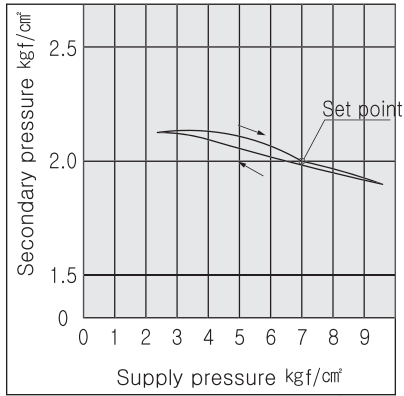

SAU 3000

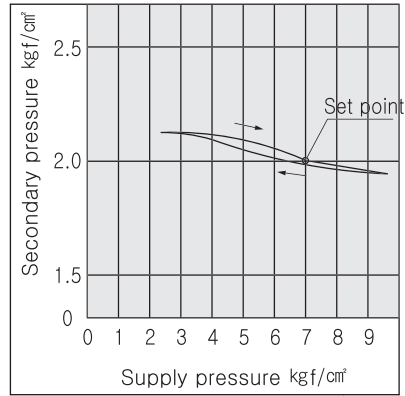

SAU 3000M

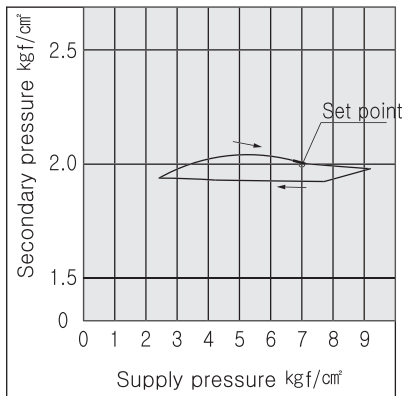

SAU 4000M-04

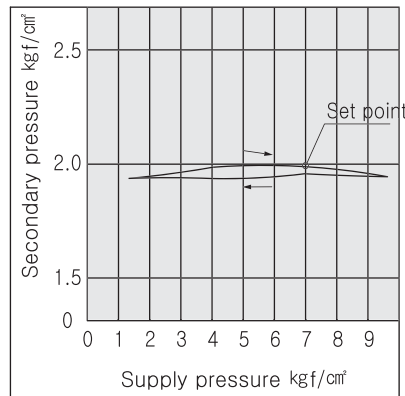

SAU 4000M-06

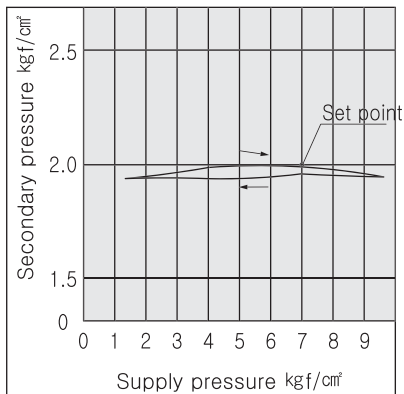

SAU 6000M

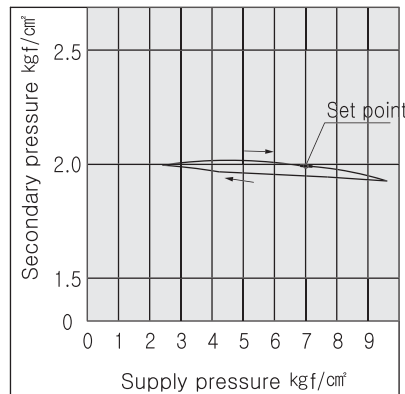

SAU

SAU(AF+AR+AL) Series

● STRUCTURE

SAU 2000M

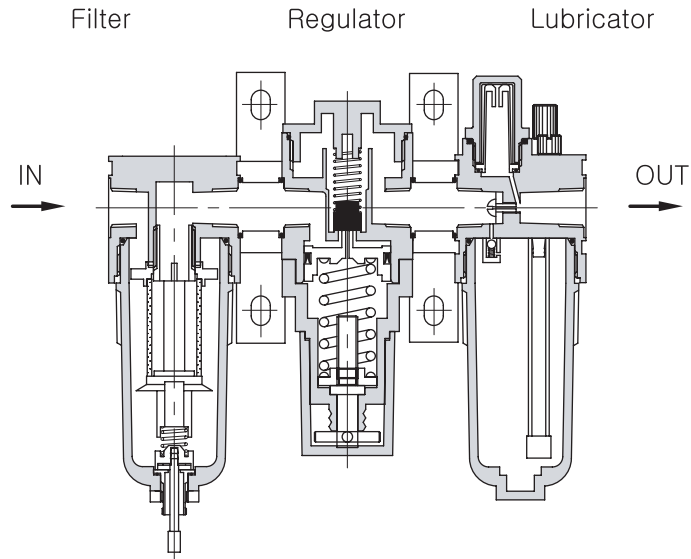

SAU 3000M

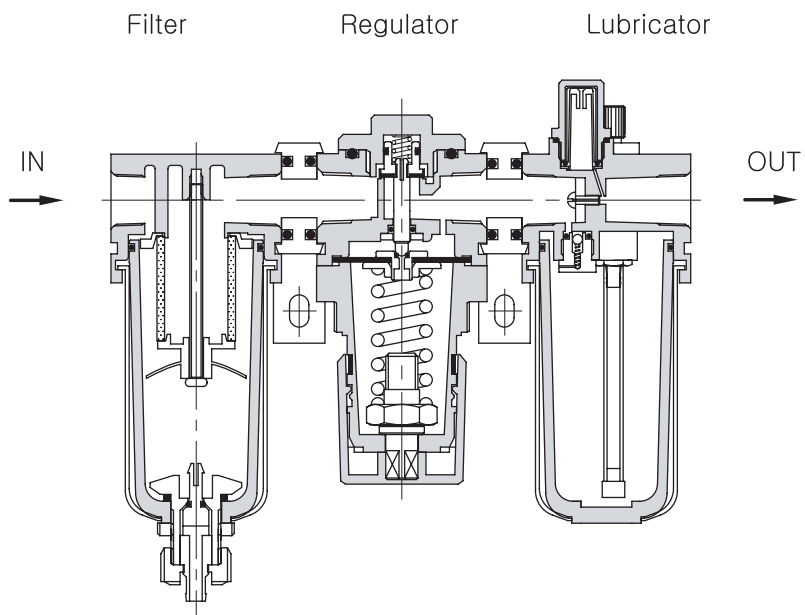

SAU(AF+AR+AL) Series

● STRUCTURE

SAU 4000M

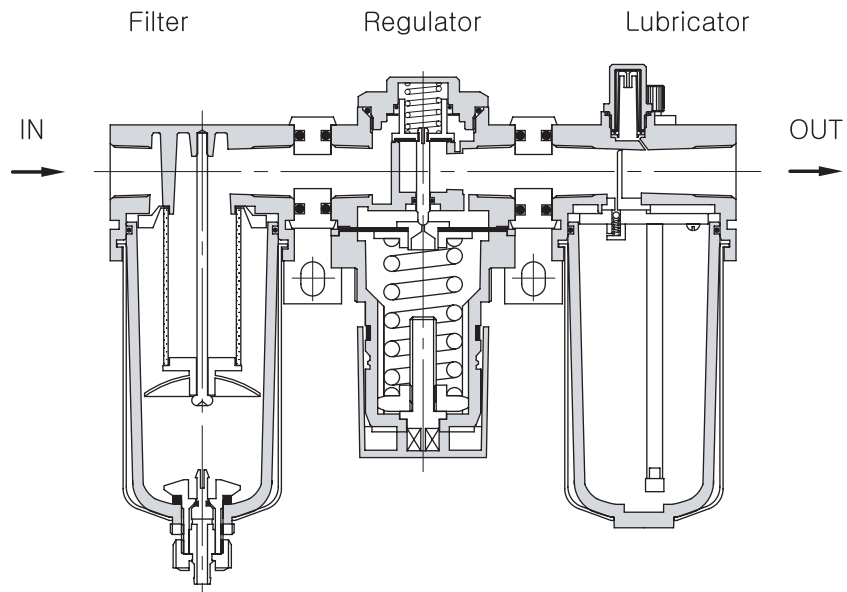

SAU 6000M

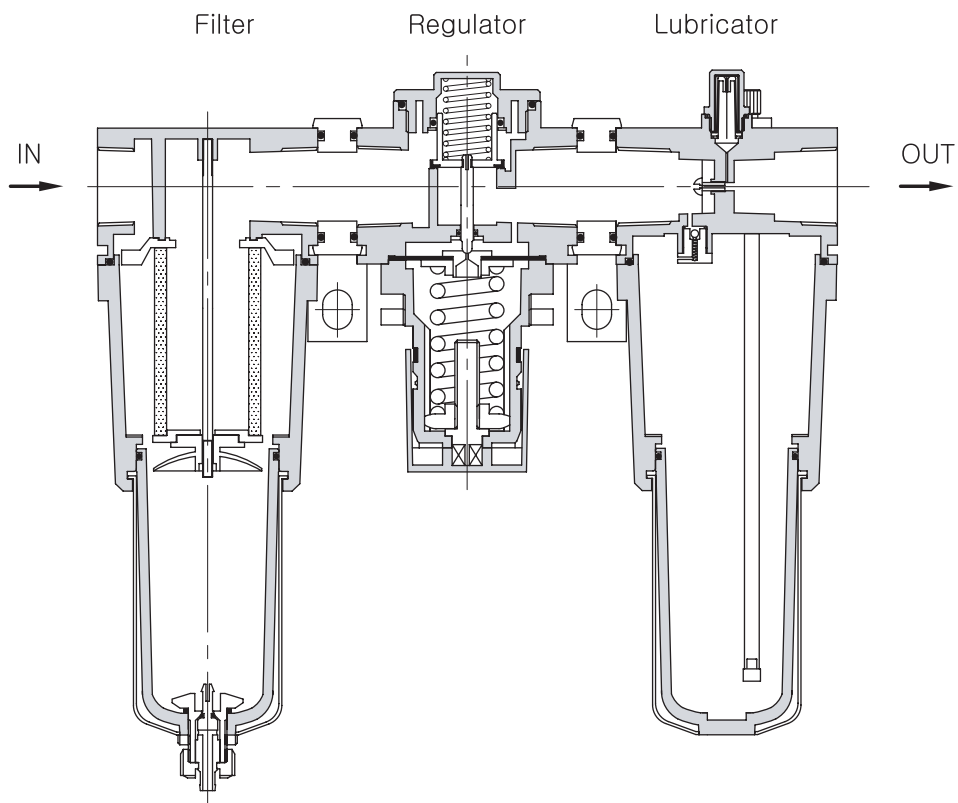

SAU(AF+AR+AL) Series

DIMENSIONS(mm)

SAU 2000M

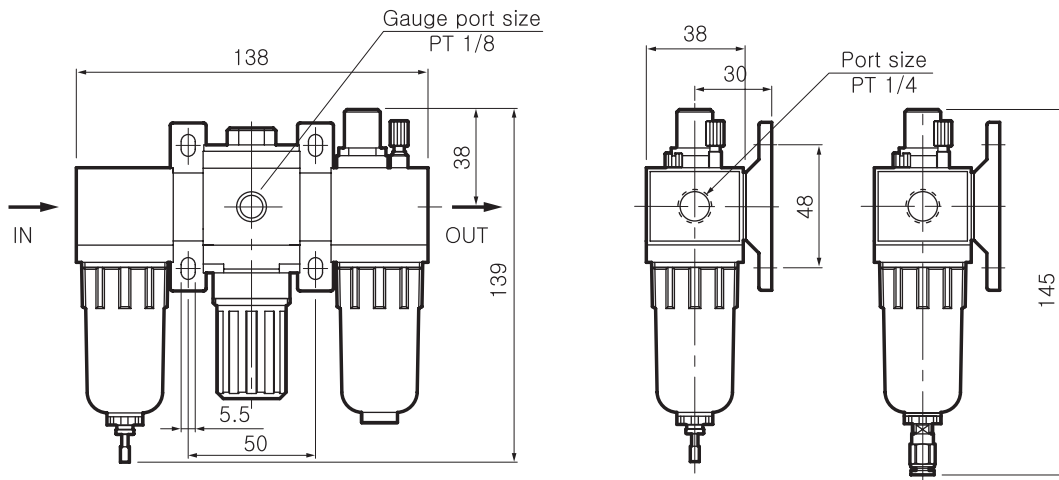

With differential pressure type auto drain

SAU 3000M

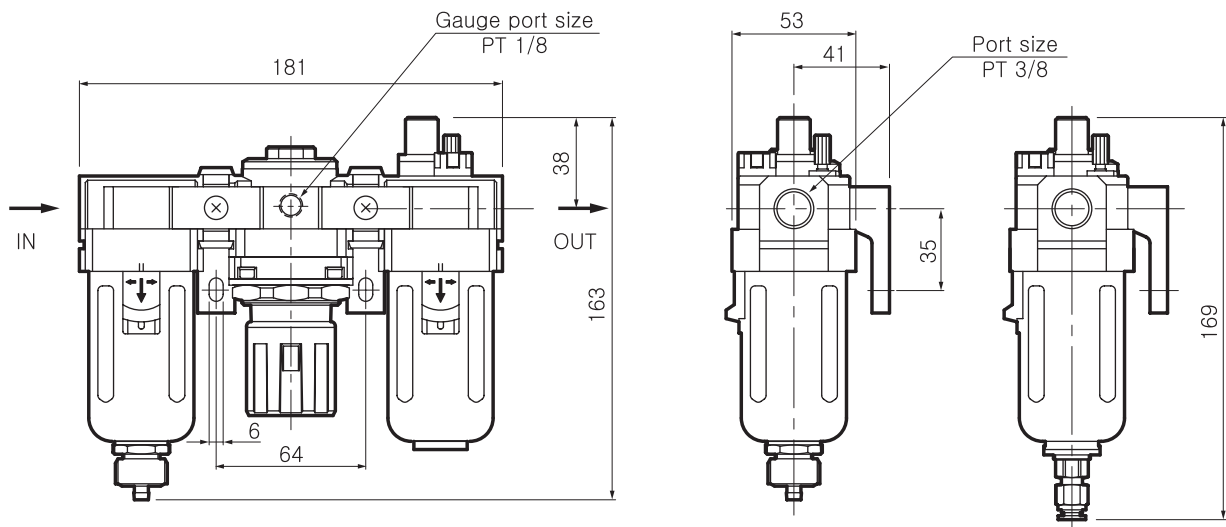

With float type auto drain

SAU(AF+AR+AL) Series

DIMENSIONS(mm)

SAU 4000M-04

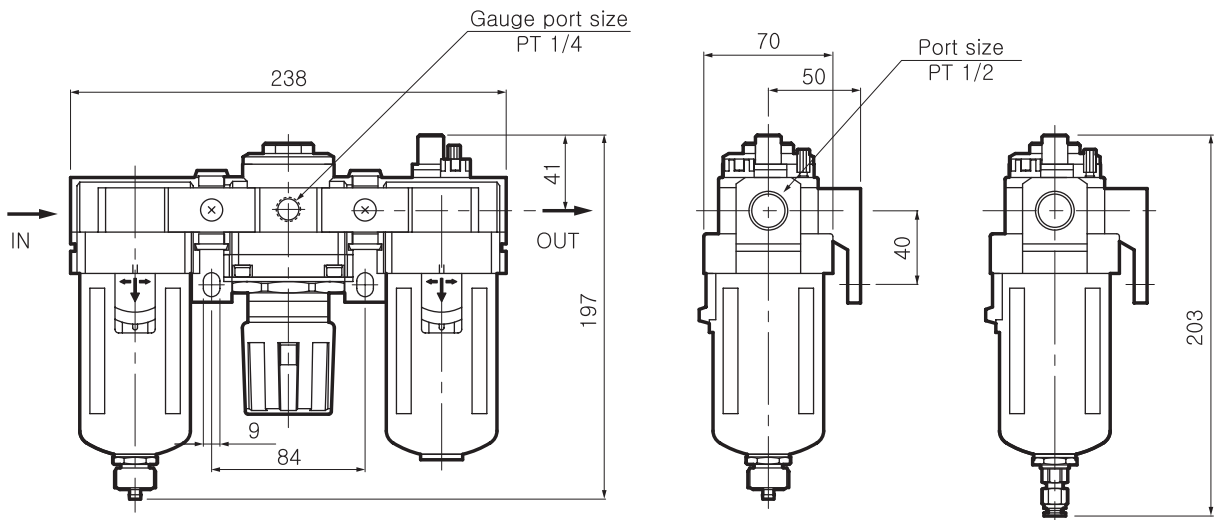

With float type auto drain

SAU 4000M-06

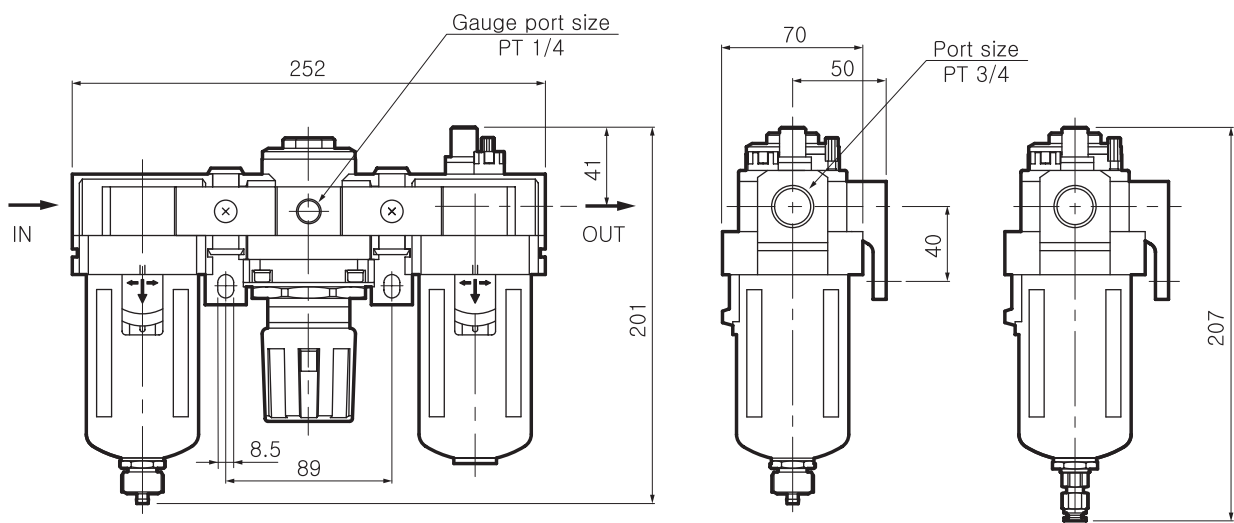

With float type auto drain

SAU

SAU(AF+AR+AL) Series

DIMENSIONS(mm)

SAU 6000M

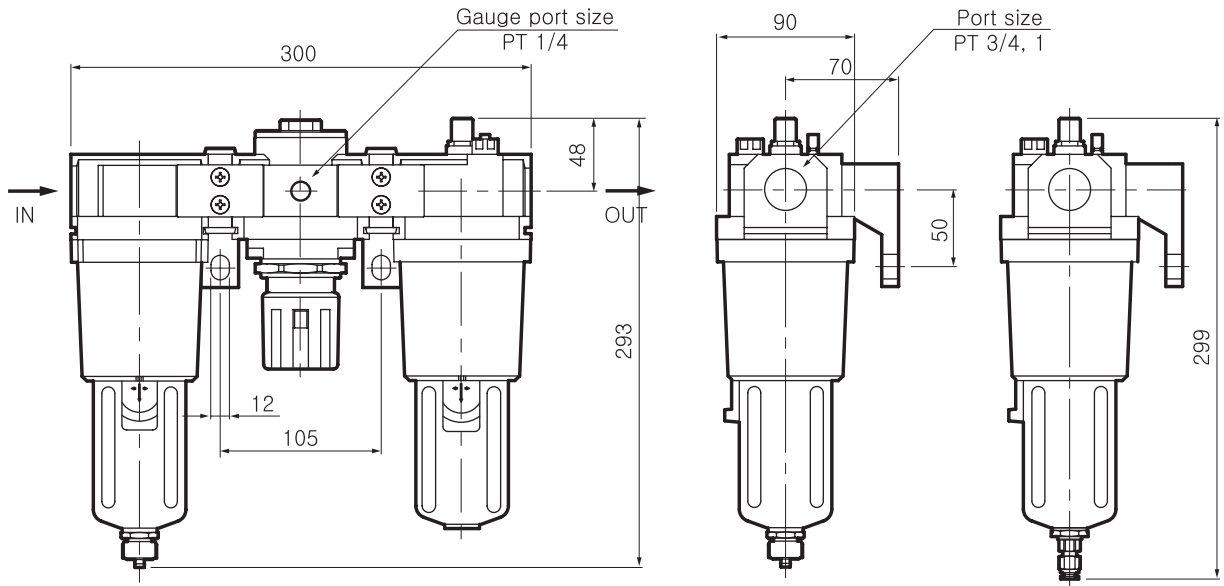

With float type auto drain

SAU(AF+AR+AL) Series

DIMENSIONS(mm) – Metal Bowl

SAU 2000M-Me

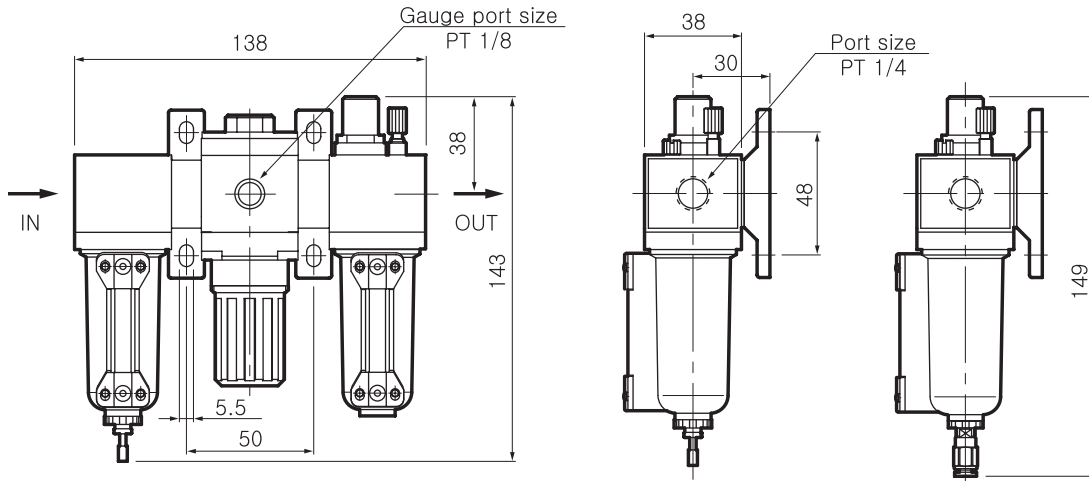

With differential pressure type auto drain

SAU 3000M-Me

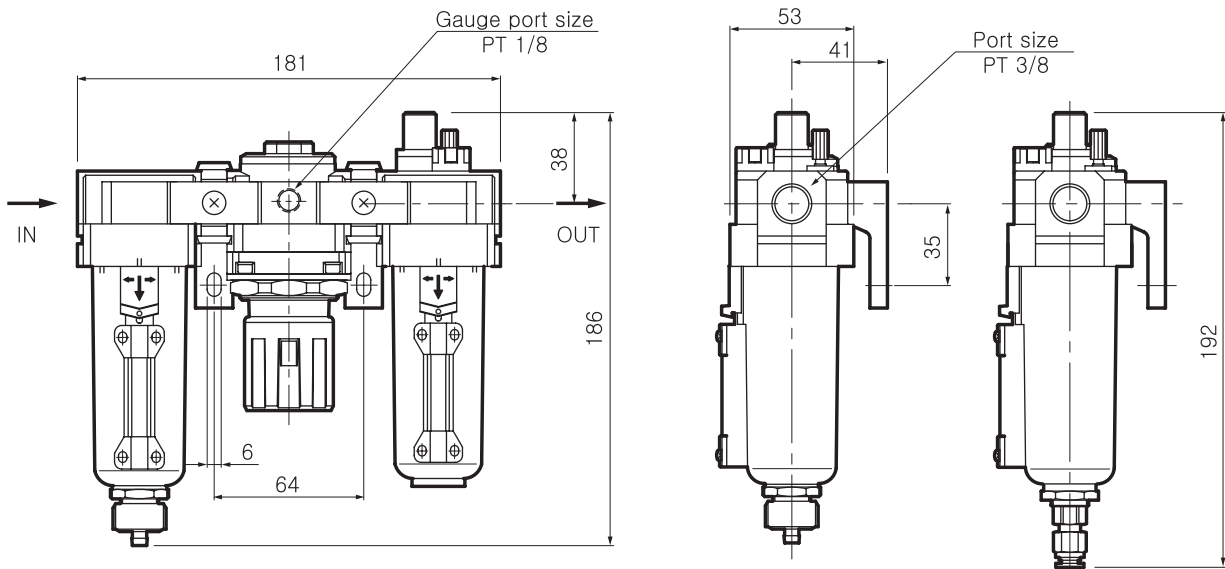

With float type auto drain

SAU

SAU(AF+AR+AL) Series

● DIMENSIONS(mm) – Metal Bowl

SAU 4000M-04-Me

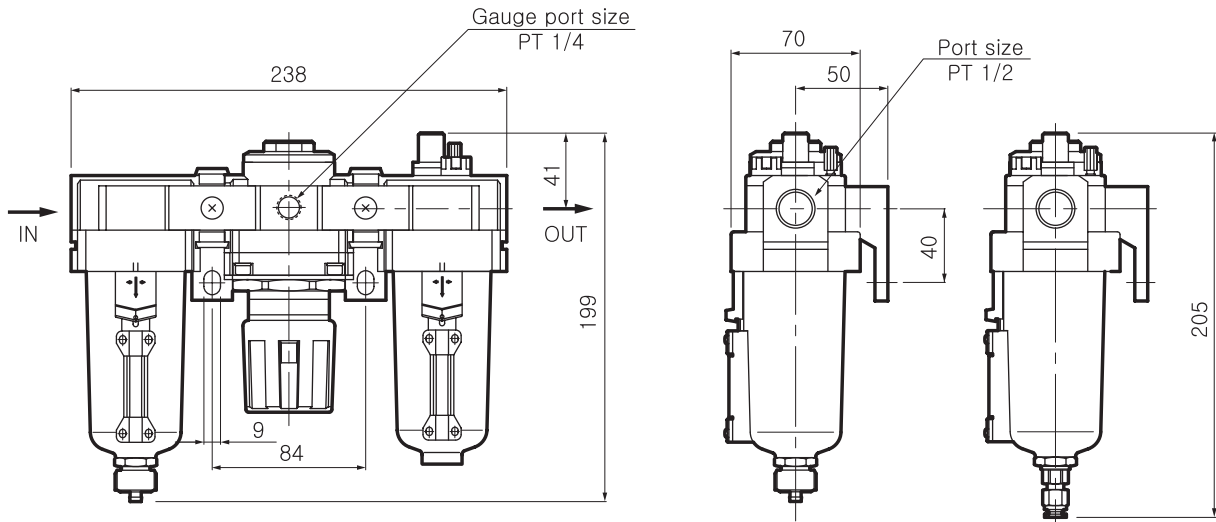

With float type auto drain

SAU 4000M-06-Me

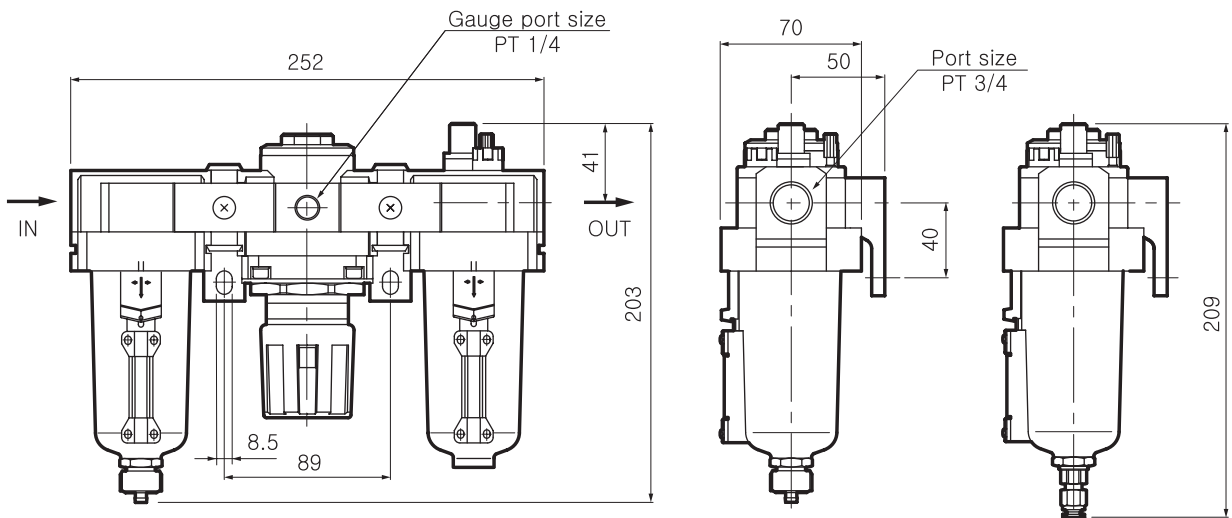

With float type auto drain

SAU(AF+AR+AL) Series

● DIMENSIONS(mm) – Metal Bowl

SAU 6000M-Me

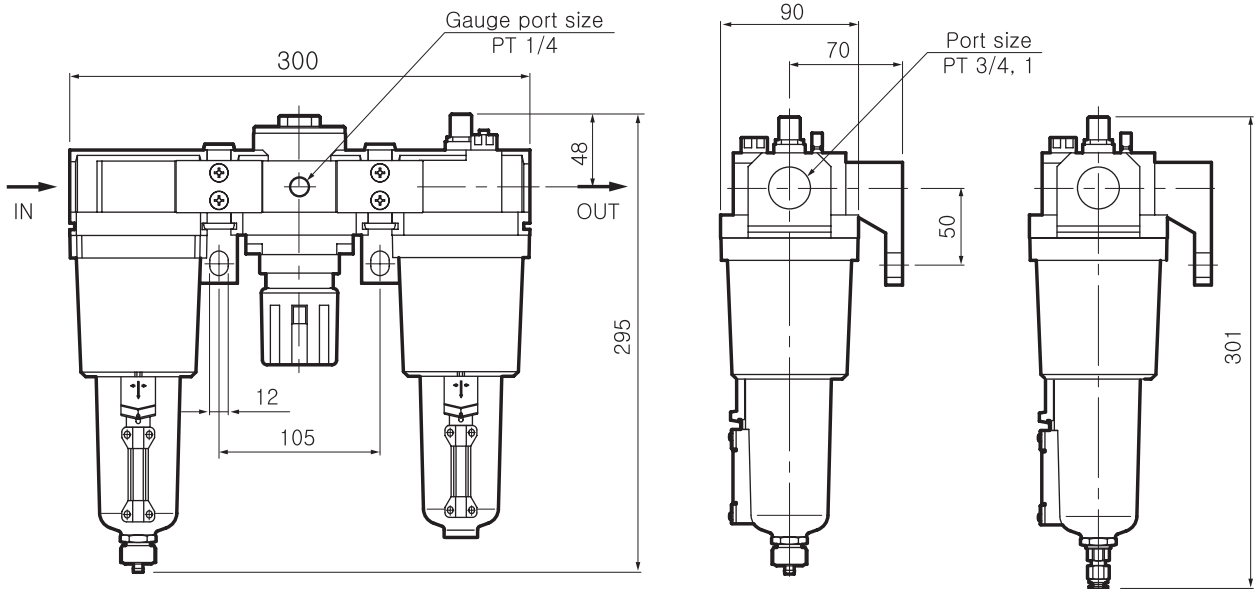

With float type auto drain

SAU

Modular type Air Unit(AW+AL)

Filter regulator + Lubricator

SAU2010M~6010M Series

- SAU series are compact type assemblies of a filter regulator and a lubricator. SAU series are most suitable to spatial application by minimizing occupied space of machinery.

How to order

SAU 30 10 M- 03 DG- Me

- 1 Air Unit
 - 20 - 1/4
 - 30 - 3/8
 - 40 - 1/2
 - 60 - 1
- 2 Body Size
 - 00 - AF+AR+AL
 - 10 - AW+AL
 - 20 - AF+AR
 - 30 - AF+AFM+AR
 - 40 - AW+AFM
 - 50 - AFM+AFD+AR
 - 60 - AW+AFM+AFD
- 3 Composition
 - 02 - Rc(PT) 1/4 "
 - 03 - Rc(PT) 3/8 "
 - 04 - Rc(PT) 1/2 "
 - 06 - Rc(PT) 3/4 "
 - 10 - Rc(PT) 1 "
- 4 Port Size
 - Nil - Manual Drain
 - D - Auto Drain
 - G - Gauge
- 5 Accessory(Optional)
 - Nil - PC Bowl
 - Me - Metal Bowl



Symbol

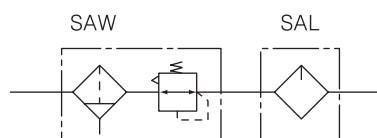

Specification

Combination	Filter regulator Lubricator
Max. supply pressure	1.5MPa [15.3 kgf/cm ²]
Max. operating pressure	0.97MPa [9.9 kgf/cm ²]
Regulating range	50~850kPa [0.5~8.7 kgf/cm ²]
Ambient and media temperature	5 ~ 60℃
Filtration	Standard:10μm, Option:2, 5, 20, 40
Recommended oil	Turbin oil (ISO VG32)
Bowl material	Poly-carbonate · Metal
Construction / Filter regulator	Relief type

Precautions

- ① Poly-carbonate bowls may be damaged and highly possible to fail if exposed to synthetic oils, thinner solvents, trichloroethylene, kerosene, chloroform, cyclohexane or other aromatic hydrocarbons and such environment exposed chemicals such as above.
- ② When auto drain is used :
Drain piping should be both 4mm or greater in diameter and less than 1m in length.
Also should avoid setting drain piping upwards.
- ③ When auto drain is out of order, it is possible to drain manually by operating one-touch-fitting vertically.
- ④ With a drain cock attached, drain can be done when the head of liquid is shown at the glass indication tube.

SAU(AW+AL) Series

● STRUCTURE

SAU 2010M

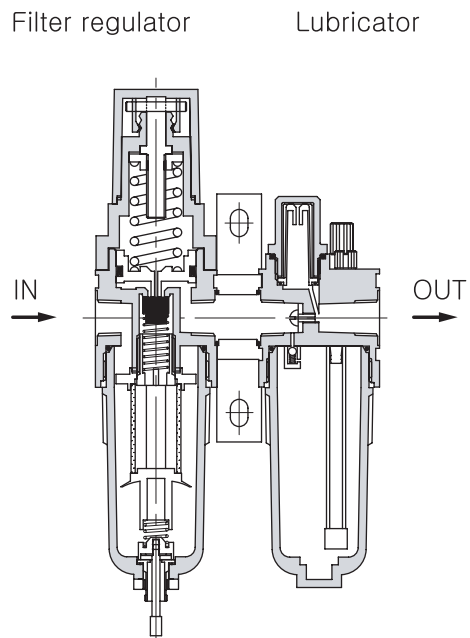

SAU 3010M

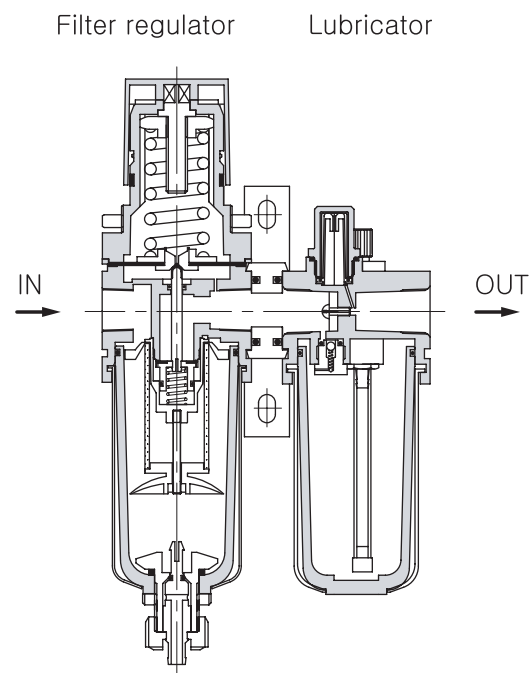

SAU(AW+AL) Series

● STRUCTURE

SAU 4010M

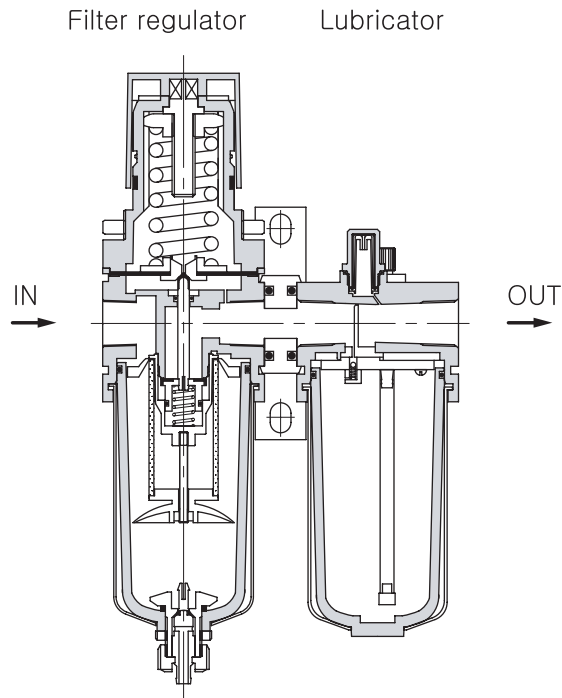

SAU 6010M

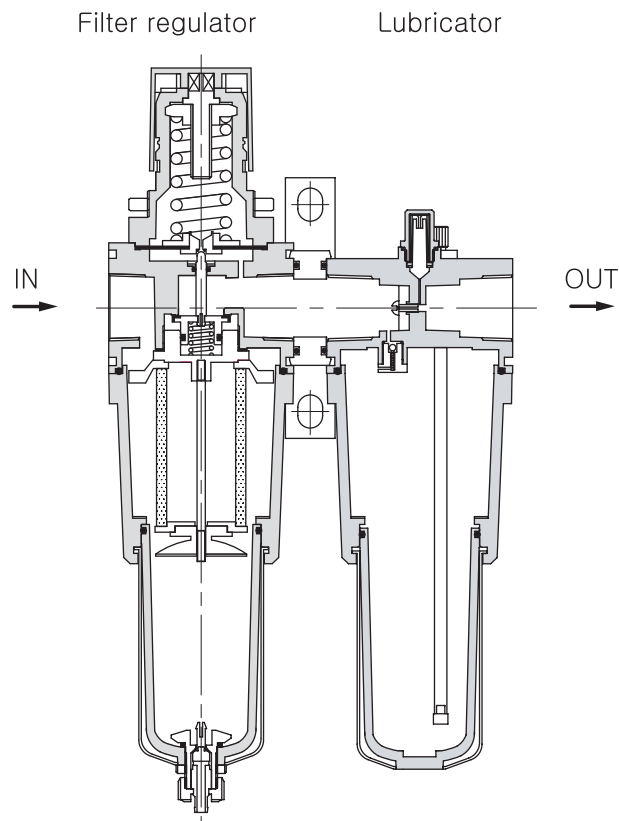

SAU(AW+AL) Series

DIMENSIONS(mm)

SAU 2010M

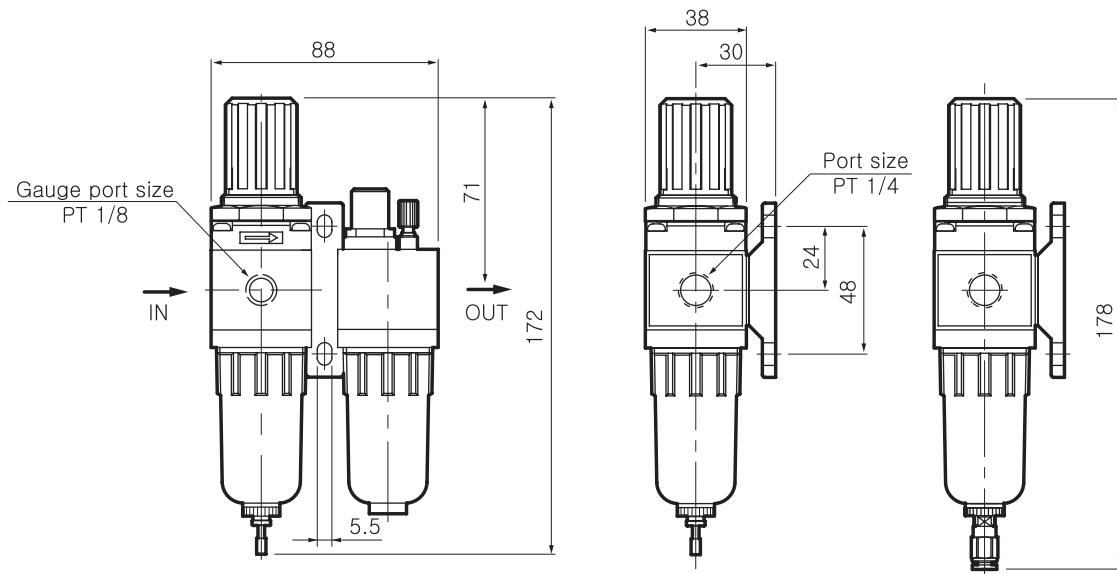

With differential pressure type auto drain

SAU 3010M

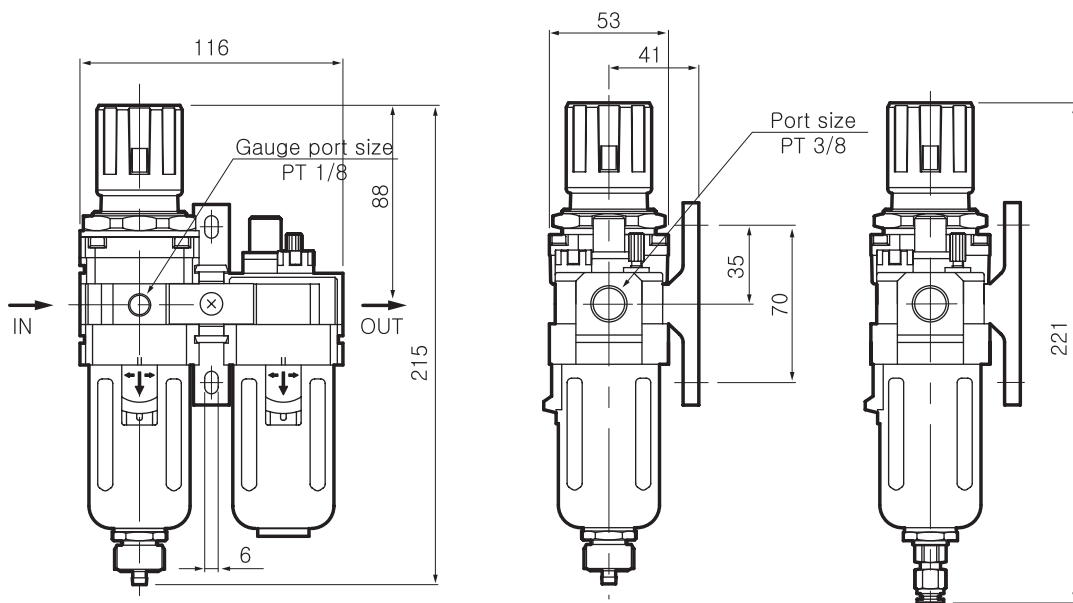

With float type auto drain

SAU

SAU(AW+AL) Series

DIMENSIONS(mm)

SAU 4010M-04

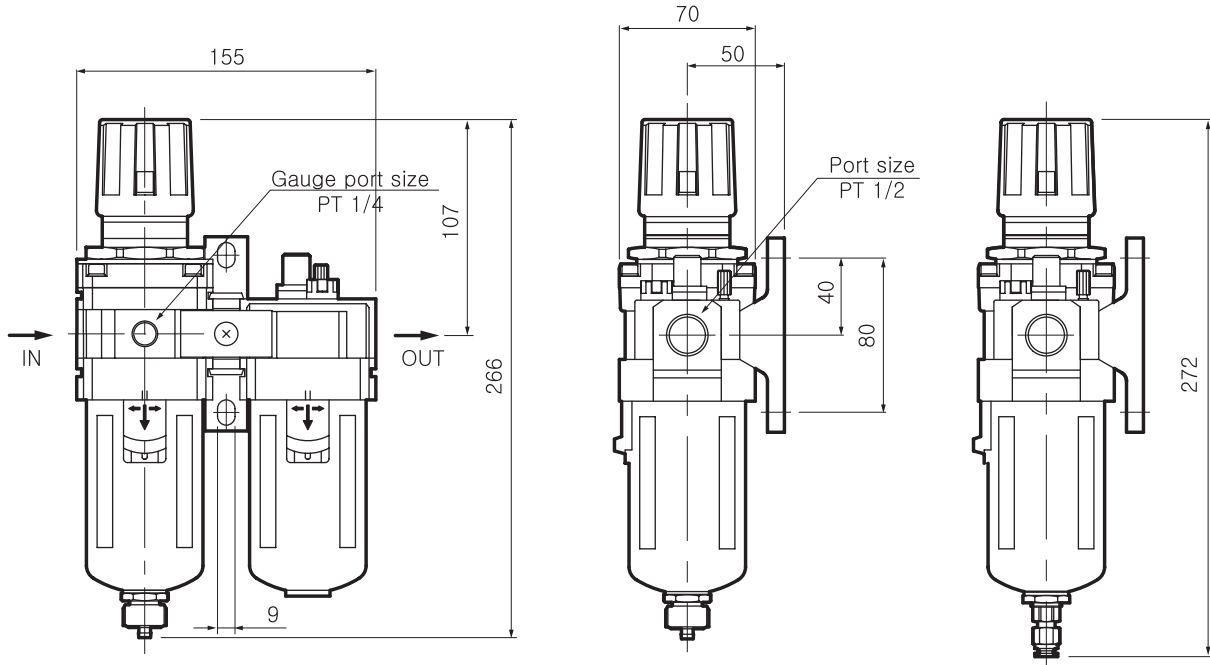

With float type auto drain

SAU 6010M

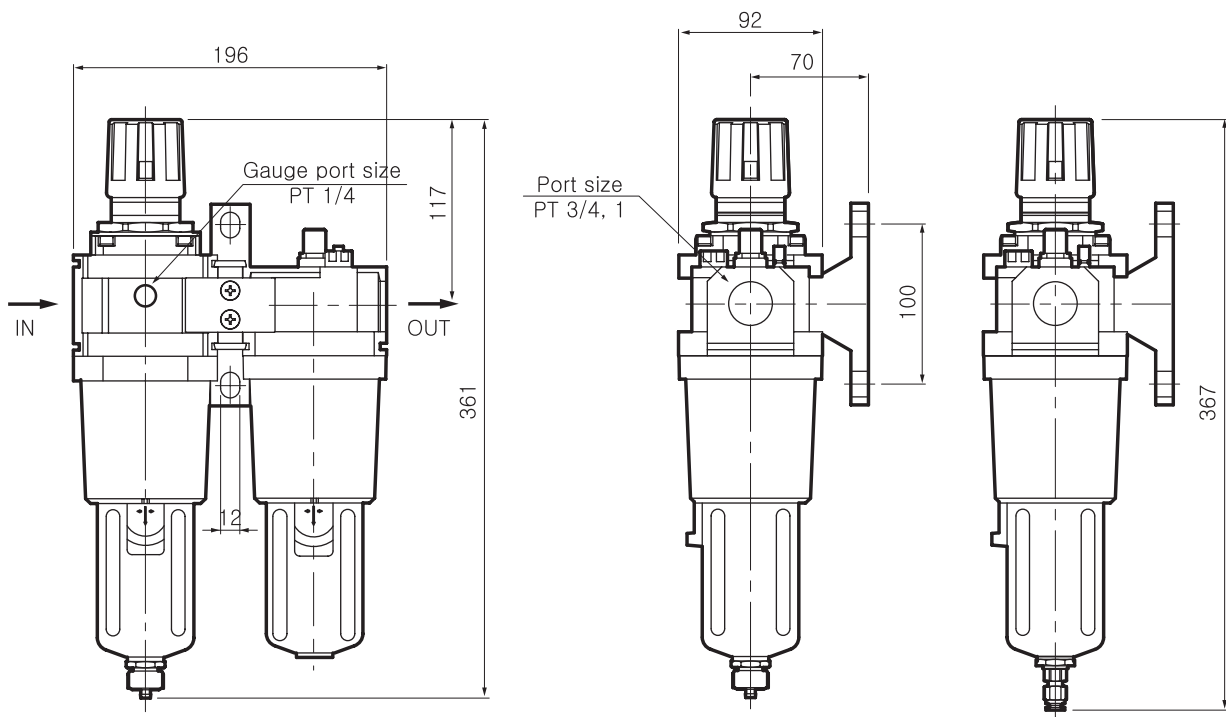

With float type auto drain

SAU(AW+AL) Series

DIMENSIONS(mm) – Metal Bowl

SAU 2010M-Me

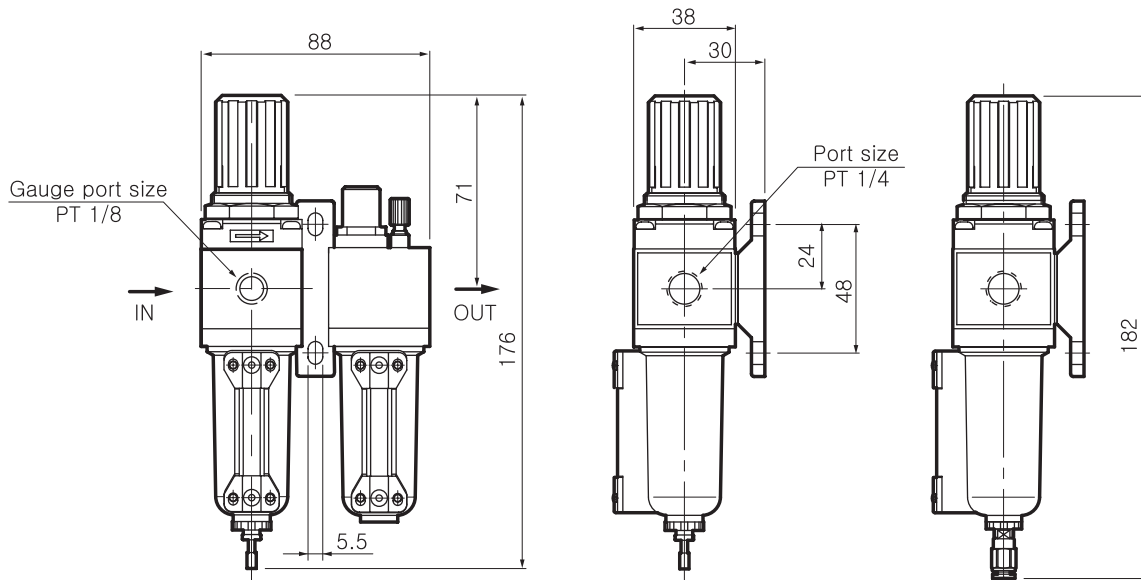

With differential pressure type auto drain

SAU 3010M-Me

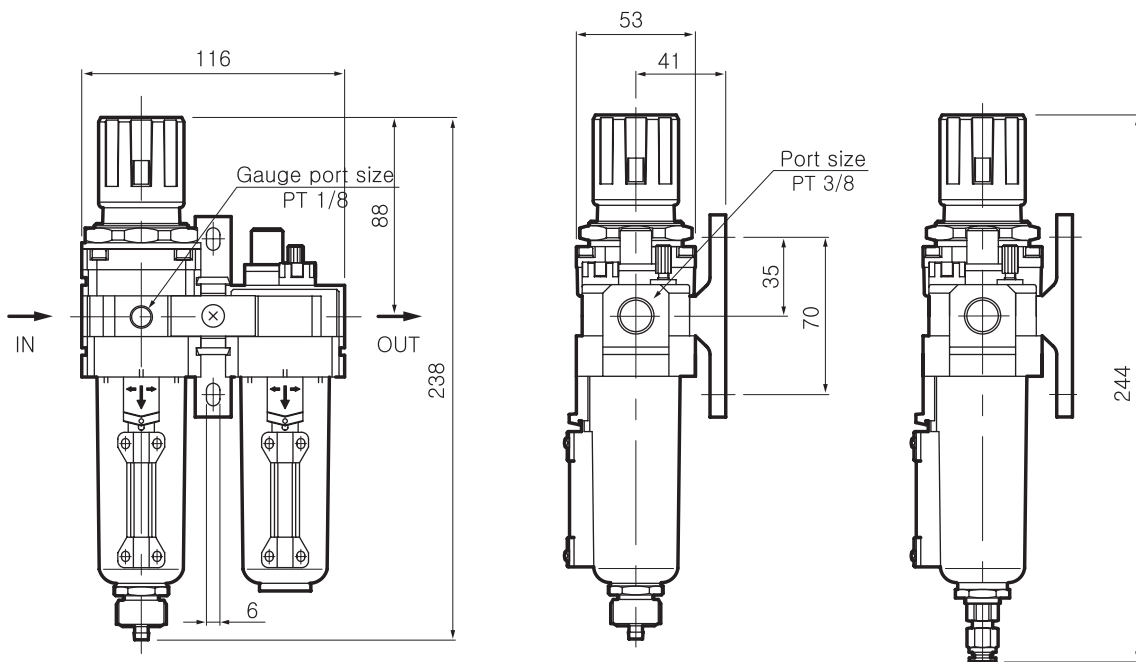

With float type auto drain

SAU(AW+AL) Series

DIMENSIONS(mm) – Metal Bowl

SAU 4010M-04-Me

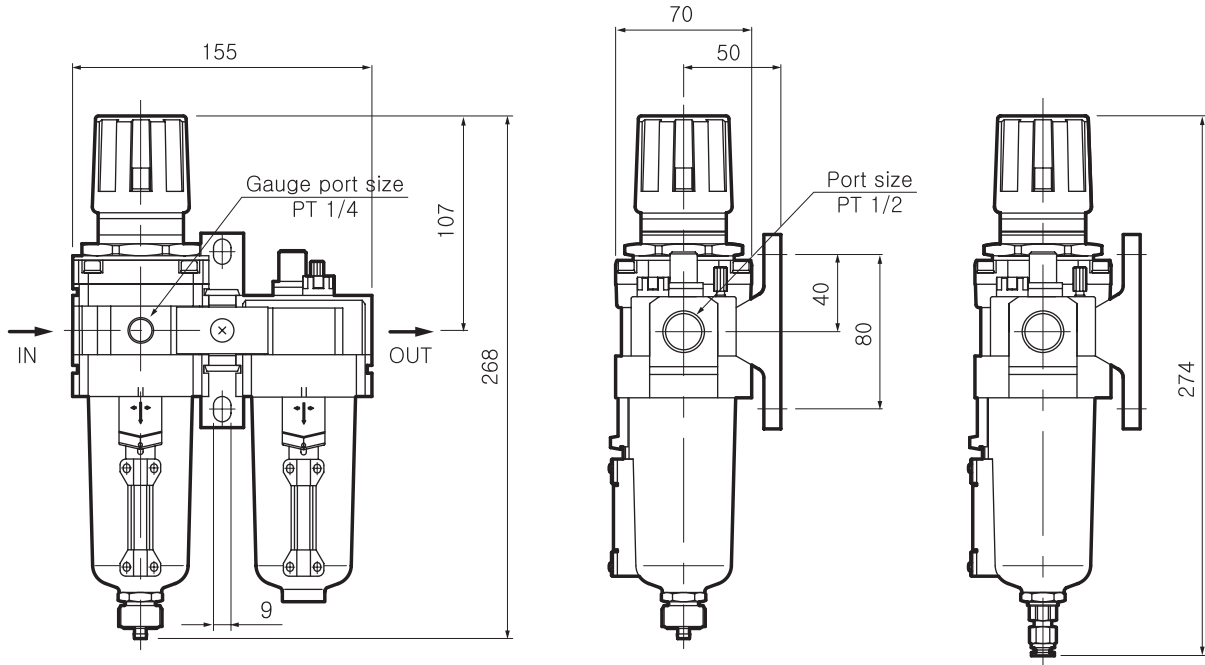

With float type auto drain

SAU 6010M-Me

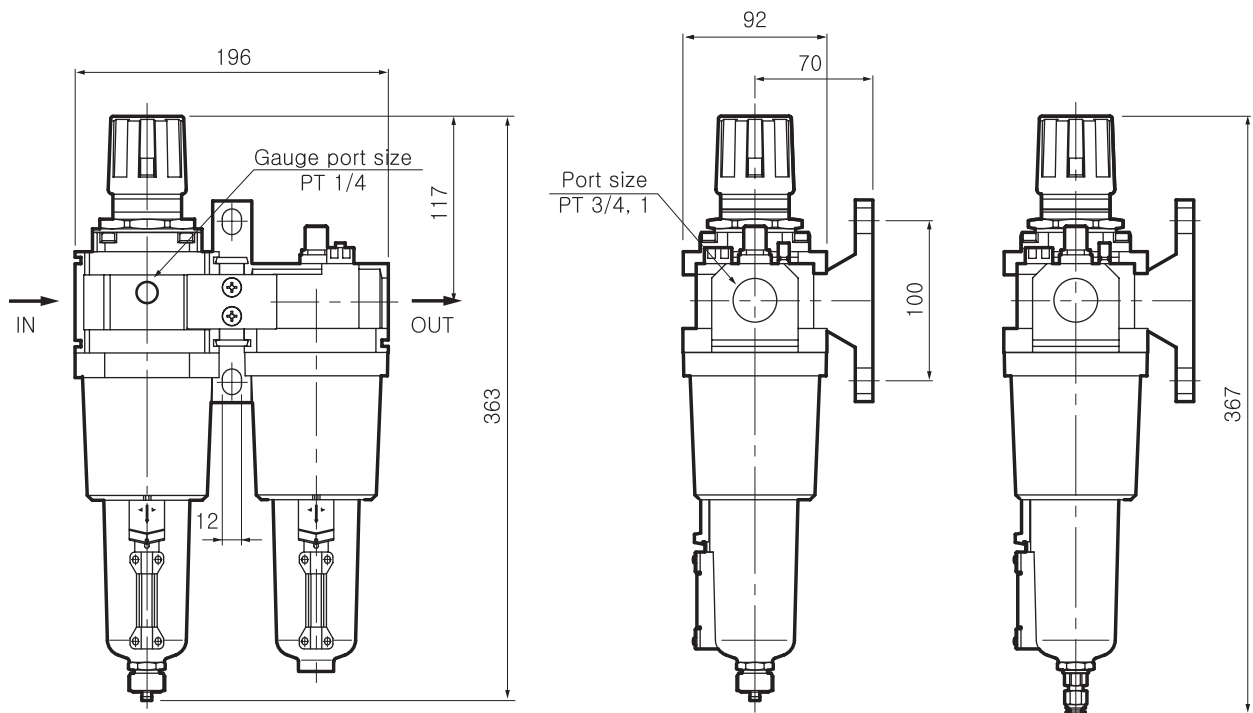

With float type auto drain

Modular type Air Unit(AF+AR)

Filter + Regulator

SAU2020M~4020M Series



SAU4020M

SAU3020M

SAU2020M

How to order

SAU 30 20 M- 03 DG - Me

- 1 Air Unit
- 2 Body Size
 - 20 - 1/4
 - 30 - 3/8
 - 40 - 1/2
- 3 Composition
 - 00 - AF+AR+AL
 - 10 - AW+AL
 - 20 - AF+AR
 - 30 - AF+AFM+AR
 - 40 - AW+AFM
 - 50 - AFM+AFD+AR
 - 60 - AW+AFM+AFD
- 4 Port Size
 - 02 - Rc(PT) 1/4 "
 - 03 - Rc(PT) 3/8 "
 - 04 - Rc(PT) 1/2 "
 - 06 - Rc(PT) 3/4 "
- 5 Accessory(Optional)
 - Nil - Manual Drain
 - D - Auto Drain
 - G - Gauge
- 6 Option
 - Nil - PC Bowl
 - Me - Metal Bowl

Symbol

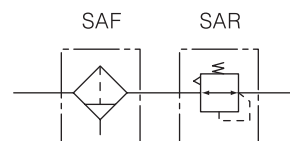

Specification

Combination	Filter Regulator
Max. supply pressure	1.5MPa [15.3 kgf/cm ²]
Max. operating pressure	0.97MPa [9.9 kgf/cm ²]
Regulating range	50~850kPa [0.5~8.7 kgf/cm ²]
Ambient and media temperature	5 ~ 60℃
Filtration	Standard:10μm, Option:2, 5, 20, 40
Bowl material	Poly-carbonate · Metal
Construction / Regulator	Relief type

Precautions

- ① Poly-carbonate bowls may be damaged and highly possible to fail if exposed to synthetic oils, thinner solvents, trichloroethylene, kerosene, chloroform, cyclohexane or other aromatic hydrocarbons and such environment exposed chemicals such as above.
- ② When auto drain is used :
Drain piping should be both 4mm or greater in diameter and less than 1m in length.
Also should avoid setting drain piping upwards.
- ③ When auto drain is out of order, it is possible to drain manually by operating one-touch-fitting vertically.
- ④ With a drain cock attached, drain can be done when the head of liquid is shown at the glass indication tube.

SAU

SAU(AF+AR) Series

● STRUCTURE

SAU 2020M

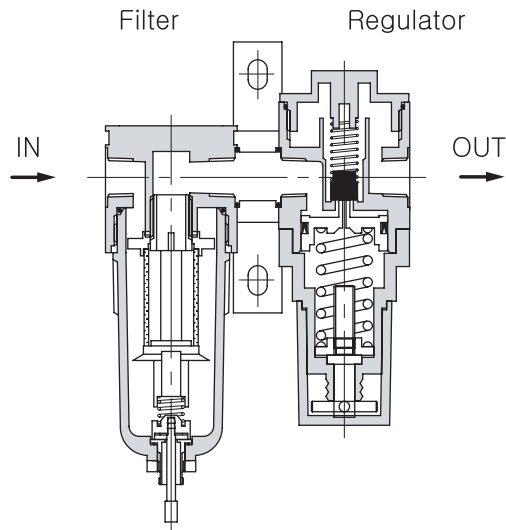

SAU 3020M

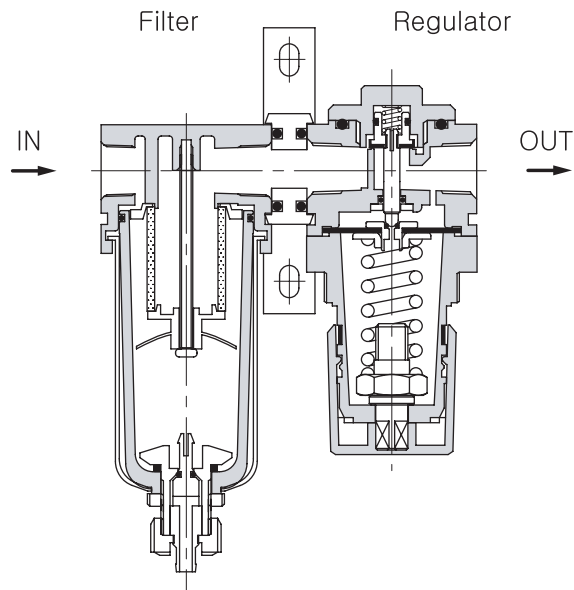

SAU(AF+AR) Series

● STRUCTURE

SAU 4020M

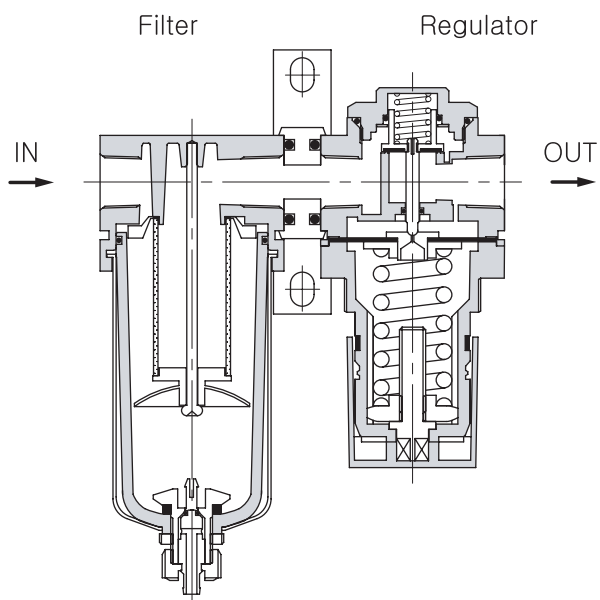

● DIMENSIONS(mm)

SAU 2020M

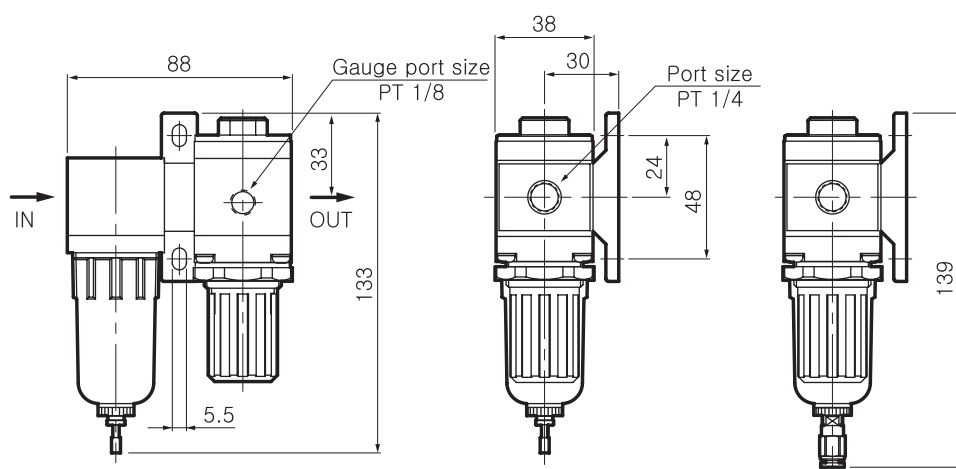

With differential pressure type auto drain

SAU

SAU(AF+AR) Series

DIMENSIONS(mm)

SAU 3020M

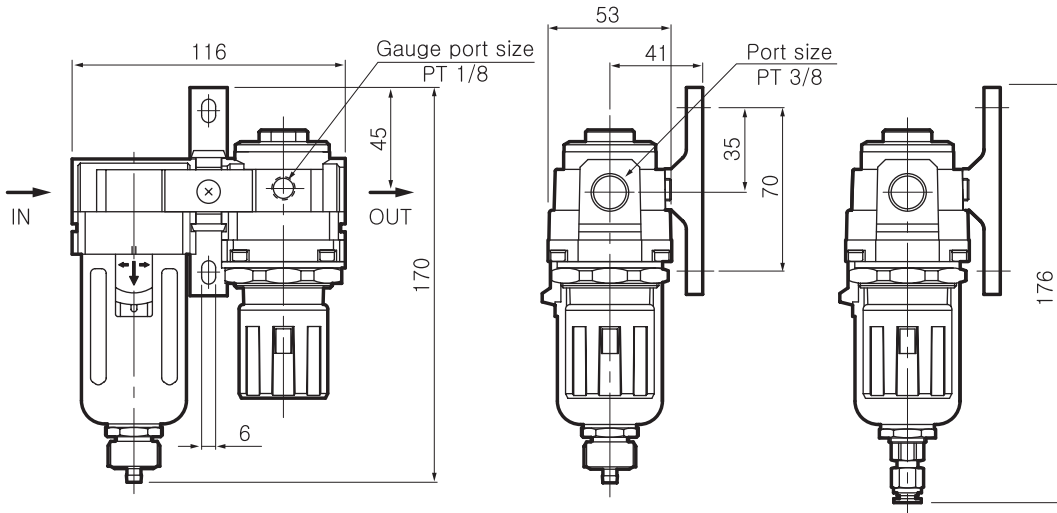

With float type auto drain

SAU 4020M

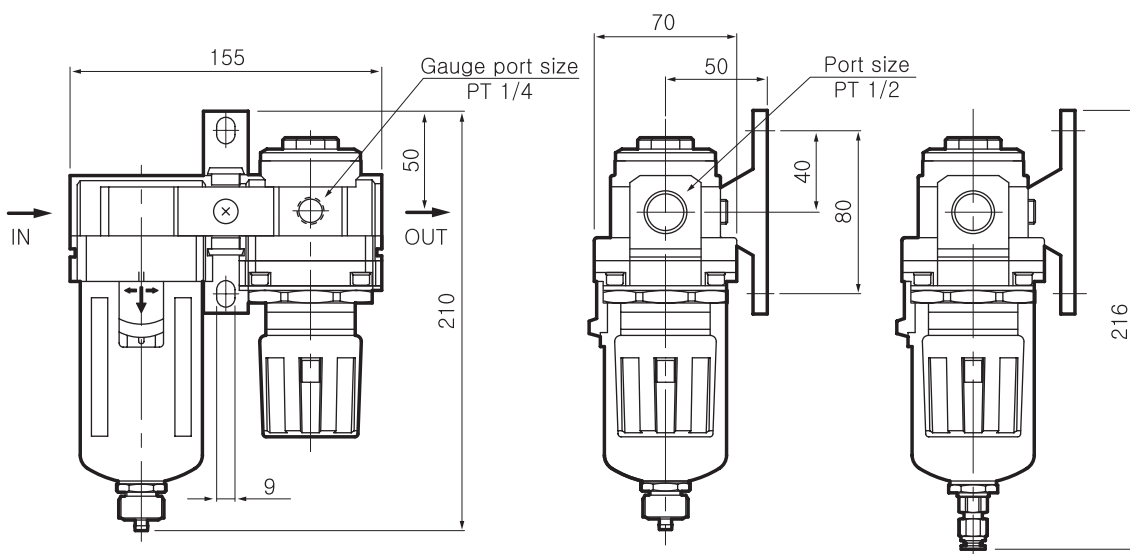

With float type auto drain

SAU(AF+AR) Series

DIMENSIONS(mm) – Metal Bowl

SAU 2020M-Me

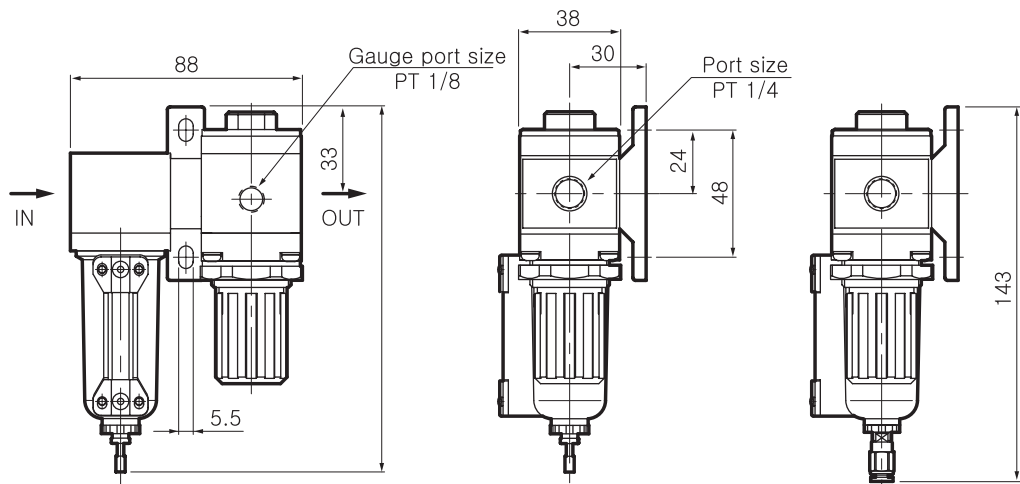

With differential pressure type auto drain

SAU 3020M-Me

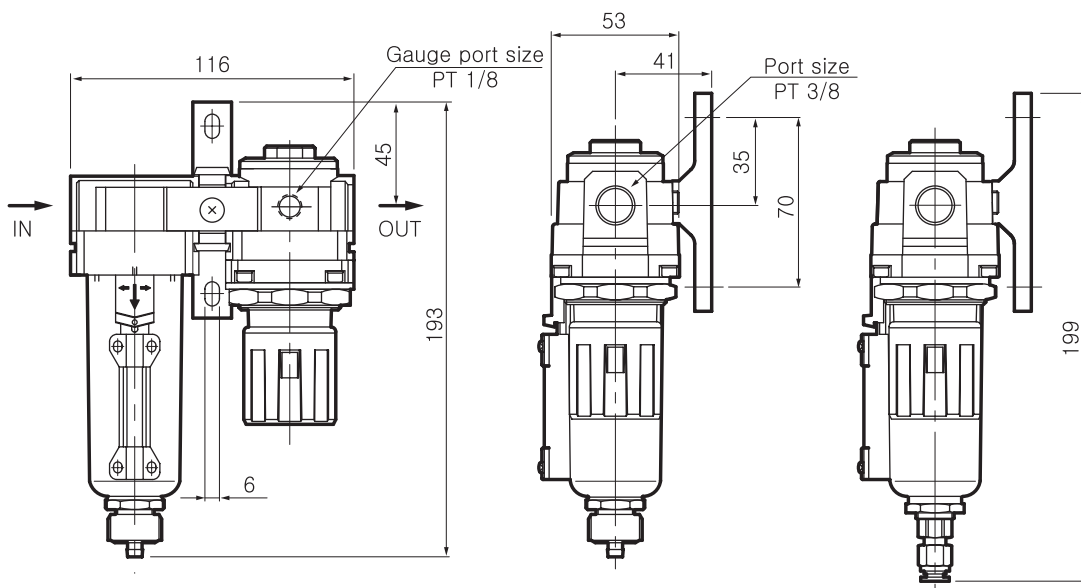

With float type auto drain



SAU(AF+AR) Series

● DIMENSIONS(mm) – Metal Bowl

SAU 4020M-Me

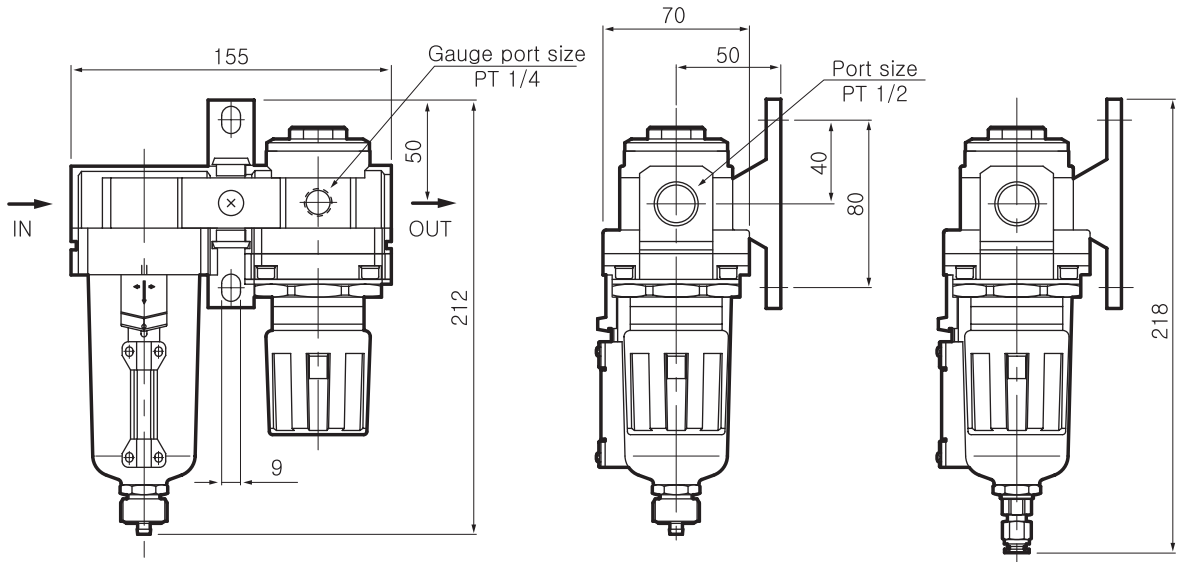

With float type auto drain